

Crisafulli 3-Point Hitch Humpback L-Series Trailer Pumps™

PTO Powered

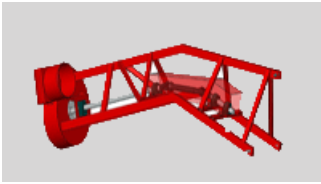

Performance capabilities. See below for the GPM and TDH capabilities of each of 13 models. See individual pages for each model for solids passing capability of each model as well as standard options for each model.

Purpose, Applications, Description. Designed to pump from steeply banked ponds, lakes, and canals Crisafulli Standard Industrial Duty Three-Point-Hitch Humpback™ Pumps are PTO powered and can pump at a 60 degree angle while keeping your tractor on the level. The Humpback™ Three-Point-Hitch Pumps volute and impeller are manufactured from 3/8" A36 mild carbon steel. The volute and impeller are mounted on a 14' long, rigid pump frame with anti-friction ball bearings (five on double suction pumps), telescopic PTO shaft, three-point-hitch connection and a short discharge pipe with an oval band to adapt to Crisafulli™ discharge tubing. Impellers for 4", 6", and 8" models are single suction; for larger models (10", 12", and 16") the impellers are double suction.

Pump Size Inches	Flow - GPM	TDH - Feet	Description	SRSC Part Number	Est. weight - pounds
16	8600	15	Regular Lift 540 RPM pump	HB16RA-3PT	1,050
12	3500	15	Regular Lift 540 RPM pump	HB12RA-3PT	950
10	3150	15	Regular Lift 540 RPM pump	HB10RA-3PT	900
10	4500	20	Intermediate Lift 540 RPM pump	HB10IA-3PT	900
8	2250	15	Regular Lift 540 RPM pump	HB08RA-3PT	800
8	3000	20	Intermediate Lift 540 RPM pump	HB08IA-3PT	800
8	3150	30	High Lift 540 RPM pump	HB08HA-3PT	800
6	1600	15	Regular Lift 540 RPM pump	HB06RA-3PT	700
6	2000	20	Intermediate Lift 540 RPM pump	HB08IA-3PT	700
6	2100	30	High Lift 540 RPM pump	HB08HA-3PT	700
4	700	15	Regular Lift 540 RPM pump	HB04RA-3PT	625
4	880	20	Intermediate Lift 540 RPM pump	HB04IA-3PT	625
4	940	30	High Lift 540 RPM pump	HB04HA-3PT	625